

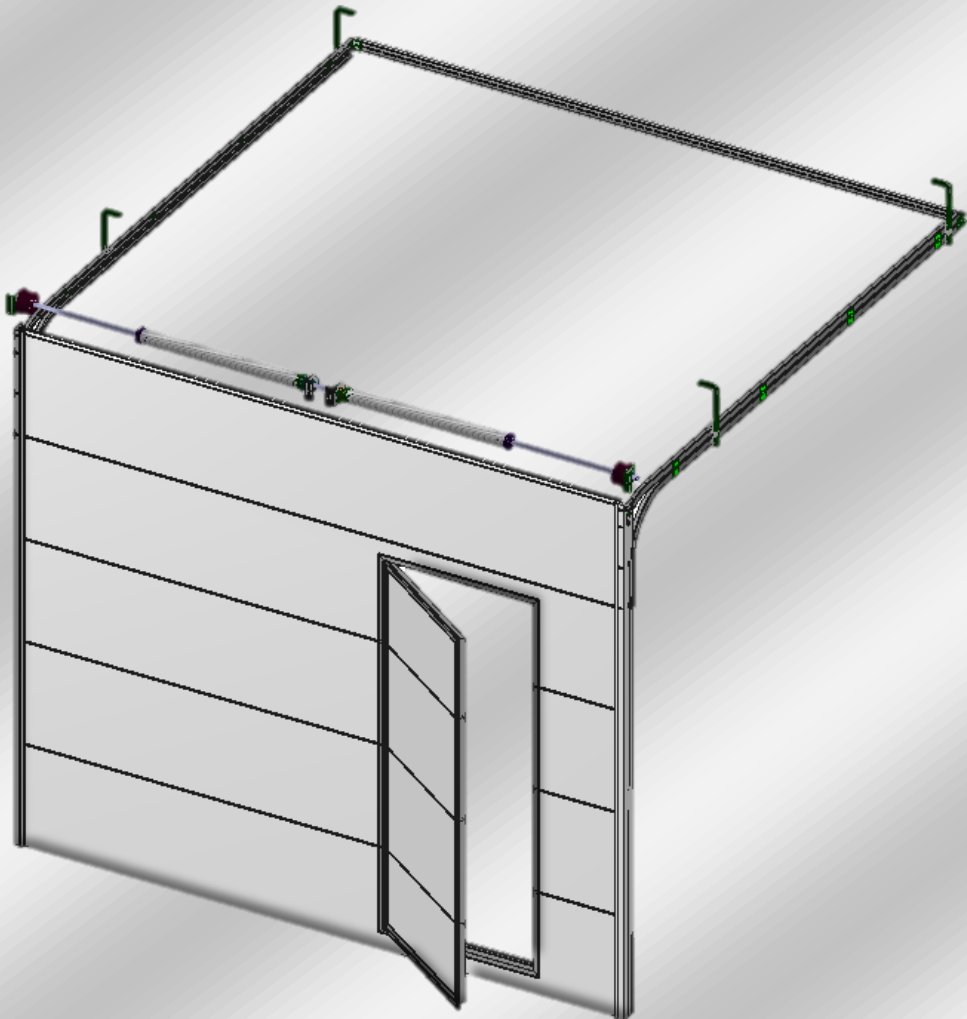

SERVICE DOOR KIT



Contents

THE PLACEMENT OF ALUMINIUM PROFILES IN THE FRAME – VIEW FROM THE FRONT SIDE	2
THE PLACEMENT OF ALUMINIUM PROFILES IN THE SERVICE DOOR – VIEW FROM THE FRONT SIDE.....	3
LIST OF ALUMINIUM PROFILES FOR SERVICE DOOR	4
ASSEMBLY INSTRUCTION FOR SERVICE DOOR	7
LIST OF ELEMENTS.....	17



THE PLACEMENT OF ALUMINIUM PROFILES IN THE FRAME – VIEW FROM THE FRONT SIDE

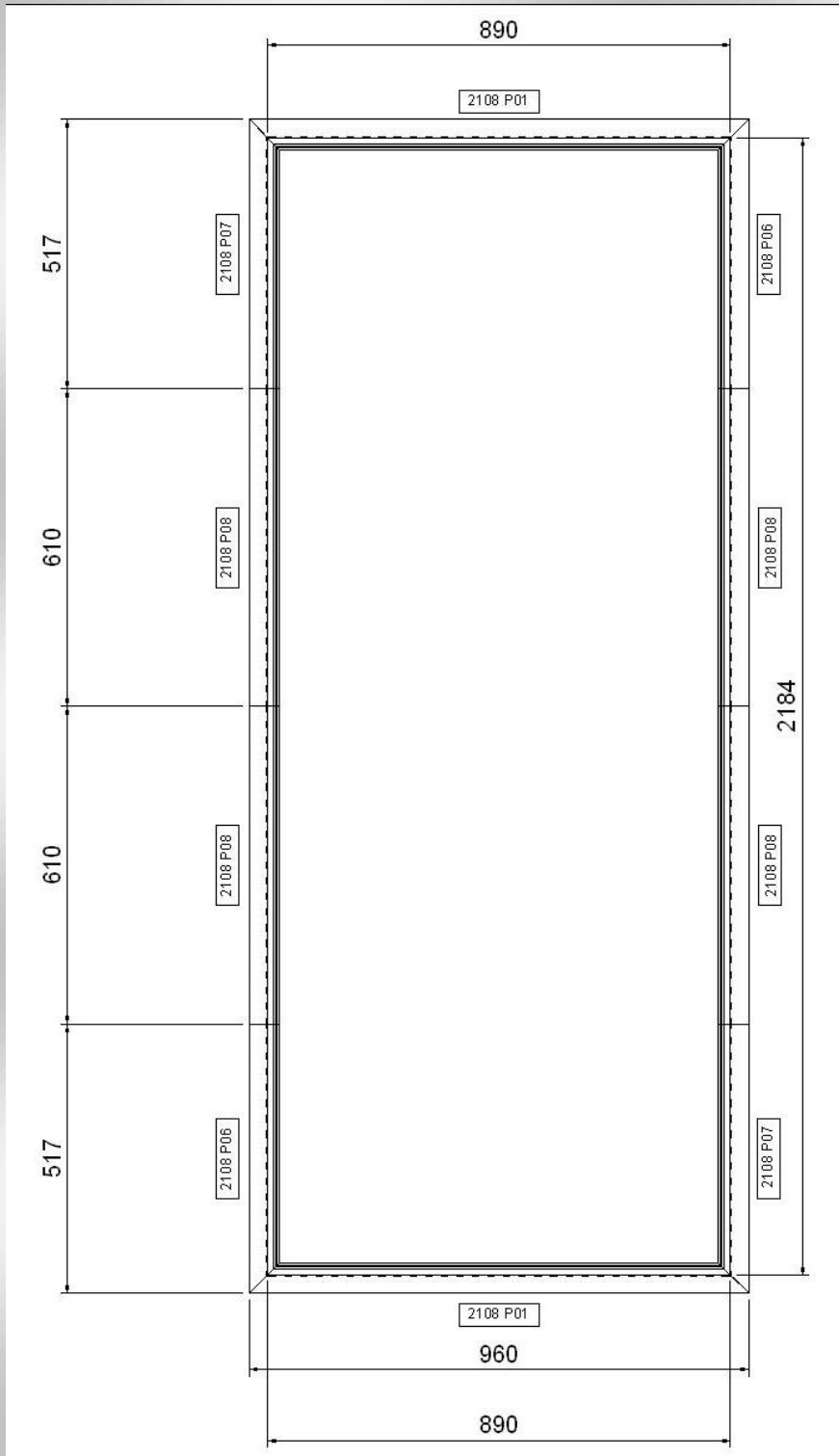



THE PLACEMENT OF ALUMINIUM PROFILES IN THE SERVICE DOOR – VIEW FROM THE FRONT SIDE

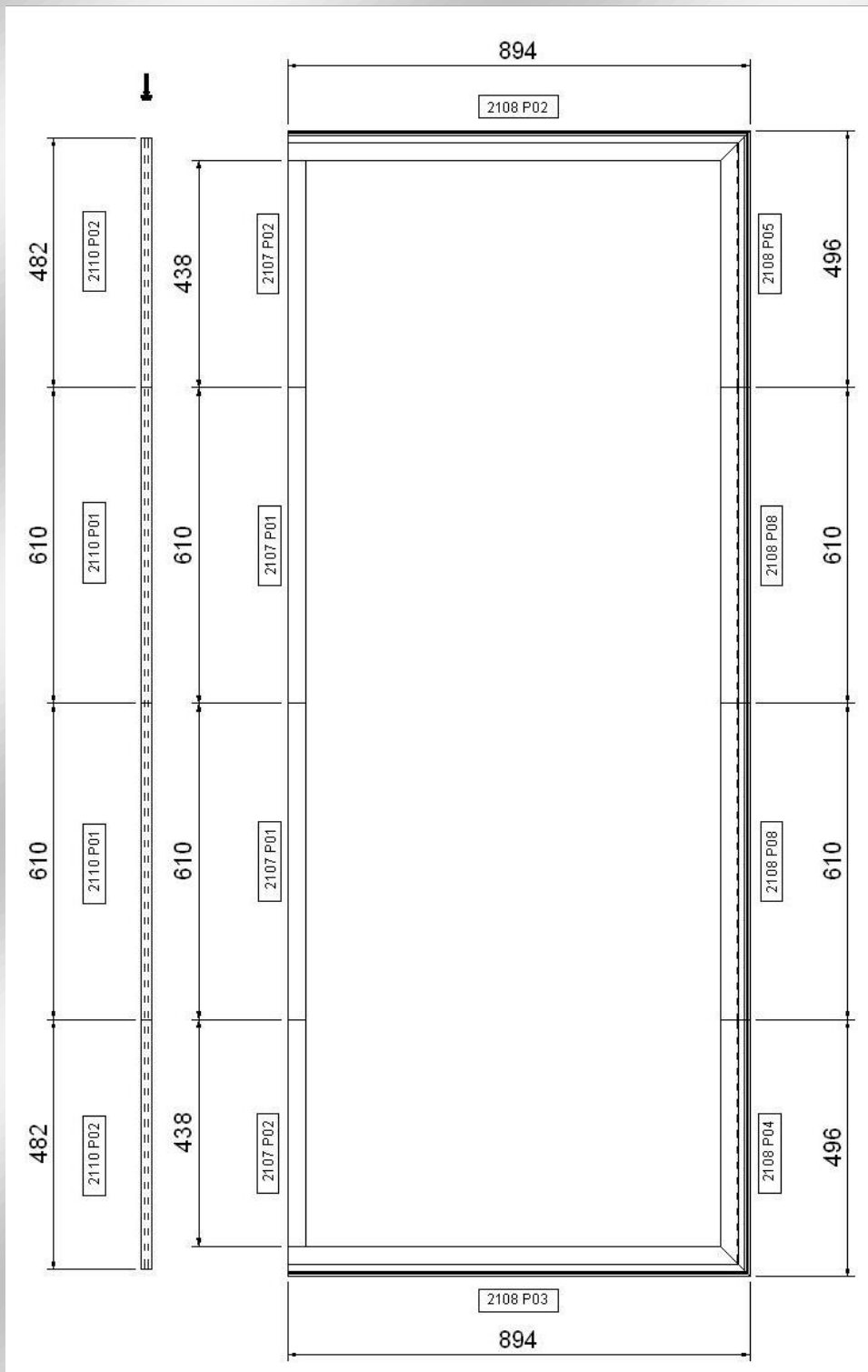

LIST OF ALUMINIUM PROFILES FOR SERVICE DOOR

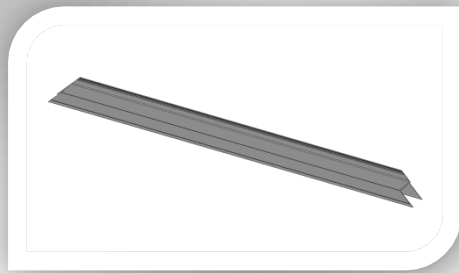

PROFILE

TYPE [h]

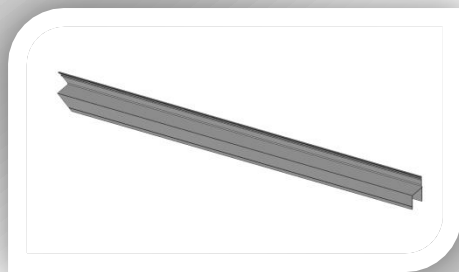
SYMBOL
LENGTH
PCS**2108 P01**
690 [mm]
2 [pcs]

PROFILE

TYPE [h]

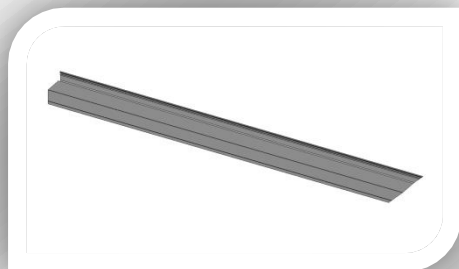
SYMBOL
LENGTH
PCS**2108 P02**
894 [mm]
1 [pcs]

PROFILE

TYPE [h]

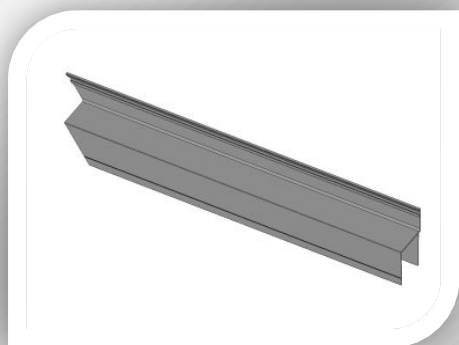
SYMBOL
LENGTH
PCS**2108 P03**
894 [mm]
1 [pcs]

PROFILE

TYPE [h]

SYMBOL
LENGTH
PCS**2108 P04**
496 [mm]
1 [pcs]

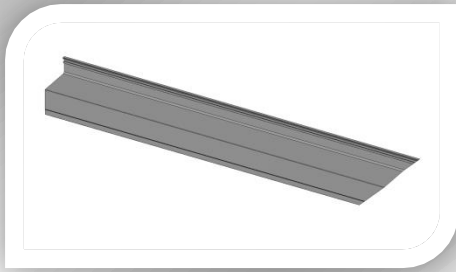

PROFILE

TYPE [h]

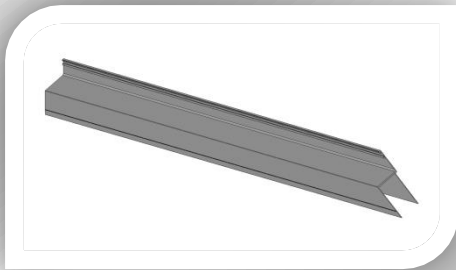
SYMBOL
LENGTH
PCS**2108 P05**
496 [mm]
1 [pcs]

PROFILE

TYPE [h]

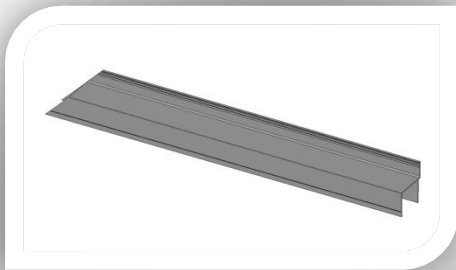
SYMBOL
LENGTH
PCS**2108 P06**
517 [mm]
2 [pcs]

PROFILE

TYPE [h]

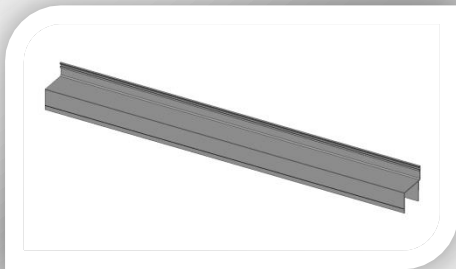
SYMBOL
LENGTH
PCS**2108 P07**
517 [mm]
2 [pcs]

PROFILE

TYPE [h]

SYMBOL
LENGTH
PCS**2108 P08**
610 [mm]
6 [pcs]

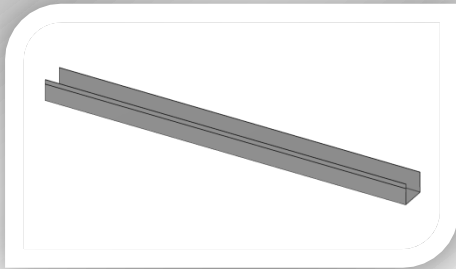

PROFILE

TYPE [c]

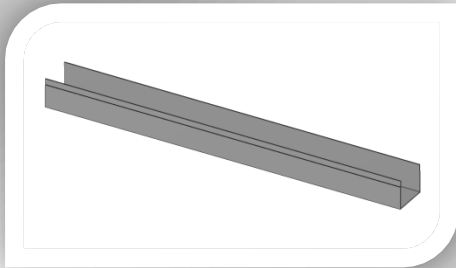
SYMBOL
LENGTH
PCS**2107 P01**
610 [mm]
2 [pcs]

PROFILE

TYPE [c]

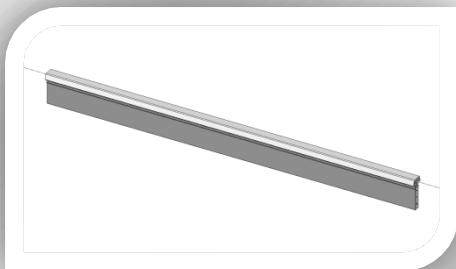
SYMBOL
LENGTH
PCS**2107 P02**
438 [mm]
2 [pcs]

PROFILE

TYPE [hinge]

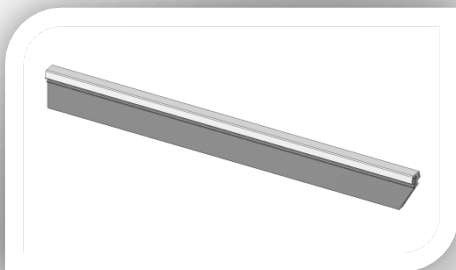
SYMBOL
LENGTH
PCS**2110 P01**
690 [mm]
2 [pcs]

PROFILE

TYPE [hinge]

SYMBOL
LENGTH
PCS**2110 P02**
482 [mm]
2 [pcs]

ASSEMBLY INSTRUCTION FOR SERVICE DOOR

Mark a rectangle with the dimensions W- 900mm, H- 2190mm and leave 150mm space from the threshold.

Attention – adjust the height to the type of the garage door. Mark the right angles in the corners of service door.

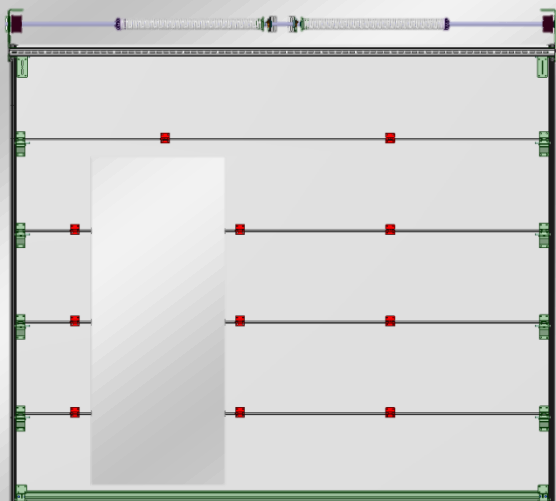
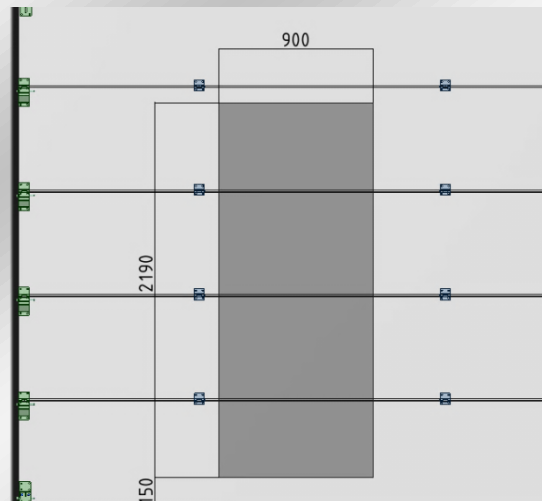

ASSEMBLE INSIDE HINGES ON THE SECTIONS- place them according to the drawing

Assemble outside hinges on the panels, two pieces per one section.

Drill $\phi 8$ holes in 4 corners of the service door.



Cut out the opening according to the marked area.



Place away the panel parts in a logical order.

H-2190mm and leave 150mm space from the threshold



THE STAGES OF INSTALLATION OF ALUMINIUM PROFILES FOR THE FRAME.THE ELEMENTS WERE DESCRIBED IN THE CONSTRUCTIONAL DRAWING ON PAGE 3.

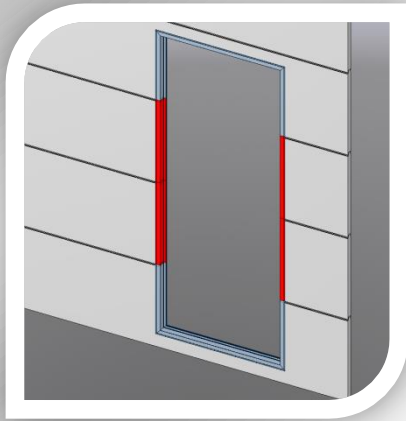
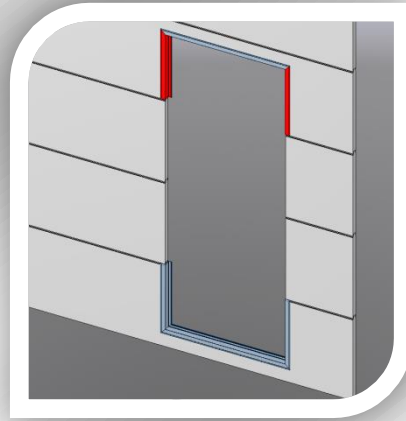
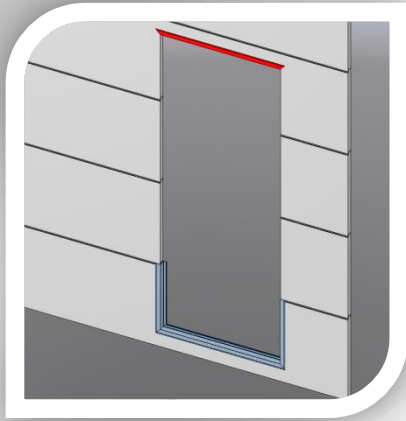
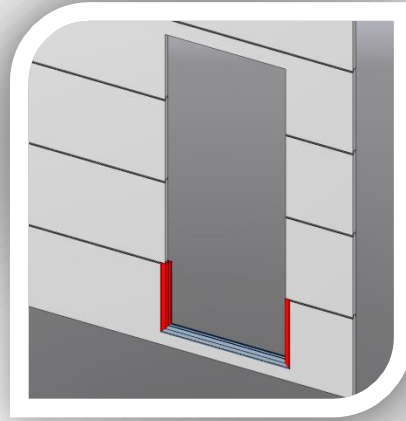
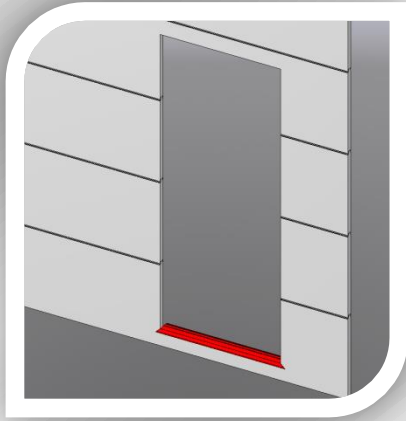

Put the first element 2108 P01– aluminium profile [h] on the threshold. Mount the higher parts of the aluminium profiles in the direction of the inside part of the garage door.



Assemble the remaining aluminium profiles [h] according to the constructional schema.

ATTENTION

When changing the height of the service door, aluminium profile [h] must be cut in the proper length.

Now adjust all of the profiles so that they connect properly.



Check all of the verticals and levels by means of a spirit level.

Fill all of the profiles with a seal.

AFTER THE ASSEMBLY OF ALUMINIUM PROFILES, THE OPENING IS OBTAINED. HEIGHT 2184MM, WIDTH 890MM



Mount all of the aluminium profiles by the means of the rivets, 3 pieces on each side.



THE STAGES OF INSTALLATION OF ALUMINIUM PROFILES FOR THE WING OF THE SERVICE DOOR.THE ELEMENTS WERE DESCRIBED IN THE CONSTRUCTIONAL DRAWING ON PAGE 4.

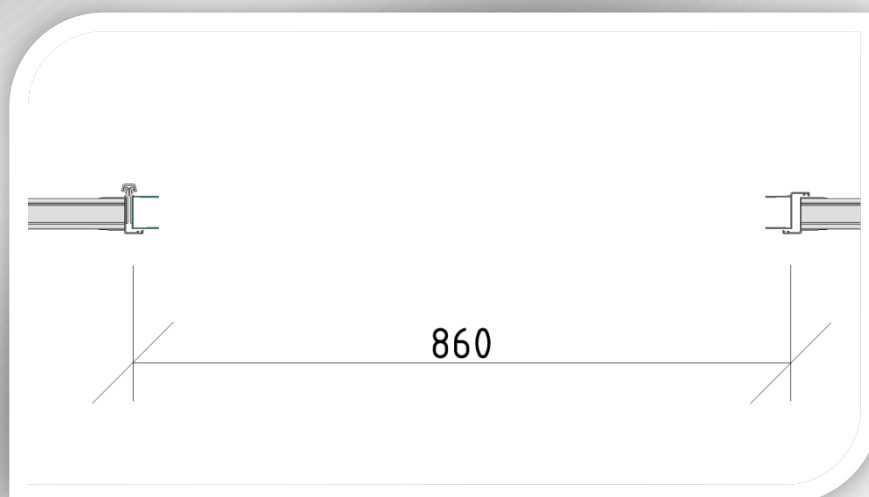

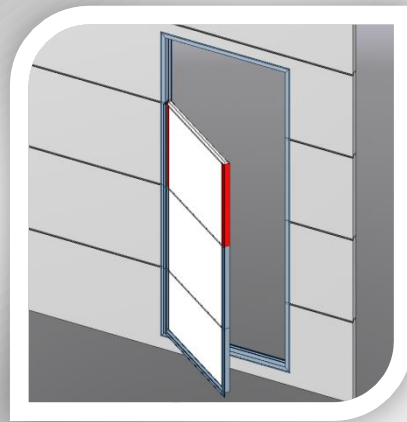
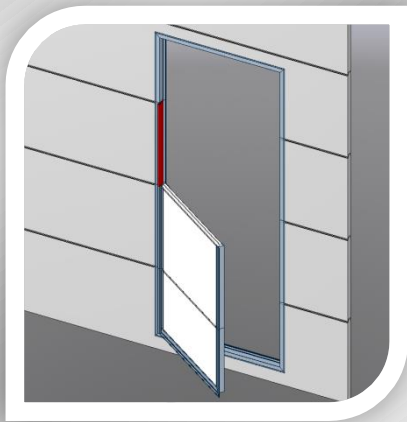
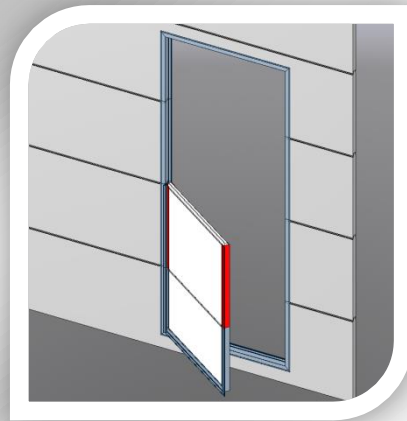
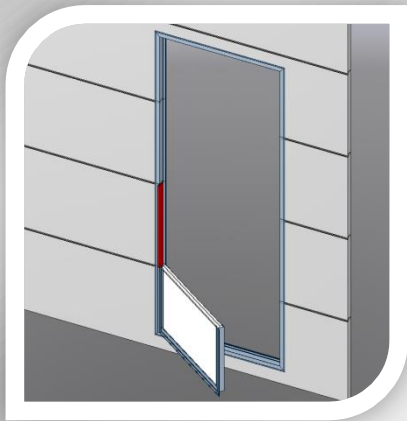
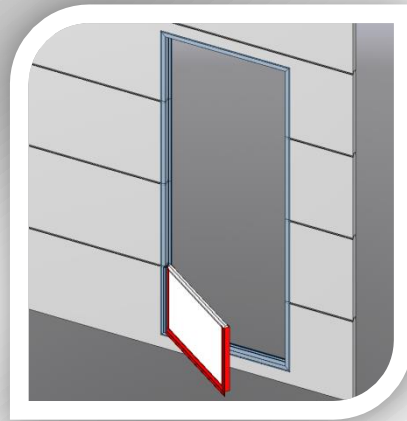
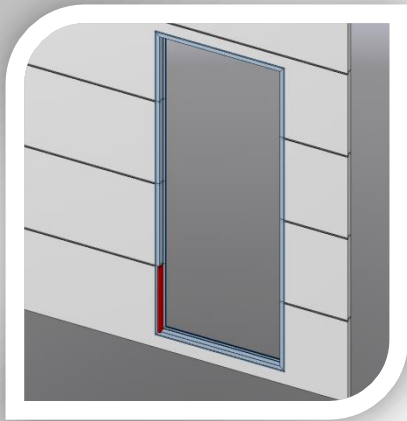

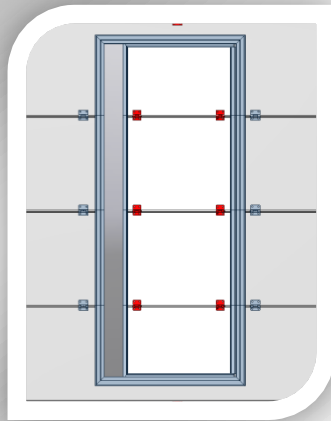
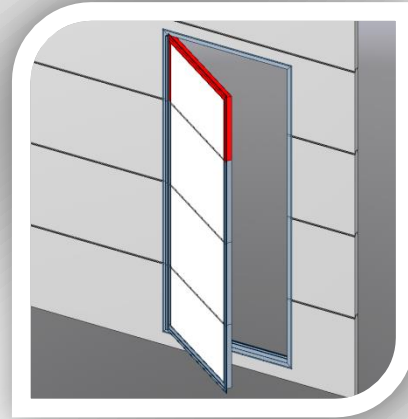
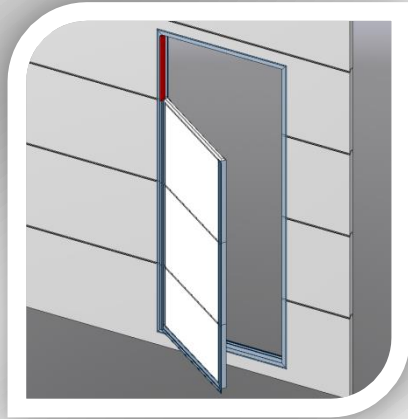

Assemble the hinges on the panels according to the drawing. Check level on each section and next screw the hinges.

Cut the sections of the panels for the wing of the service door to the width of 860mm. Adjust the height of the first section to the height of the panel in the garage door. Keep free space of 8 mm from the threshold.

Mount the elements of the aluminium hinge with 1,5 mm free space on the outside of the frame of service door. Mount the section to the aluminium hinge from the side of aluminium profile [c]. On the opposite side there should be a free space of 10mm.



Do not change the height of sections 2 and 3.
During the installation of the aluminium profiles, act according to the constructional schema for the wing of the service door.
Join the particular sections by means of outside hinges.



Adjust the last section when changing the height of the service door.

Remove all of the possible irregularities by the file.

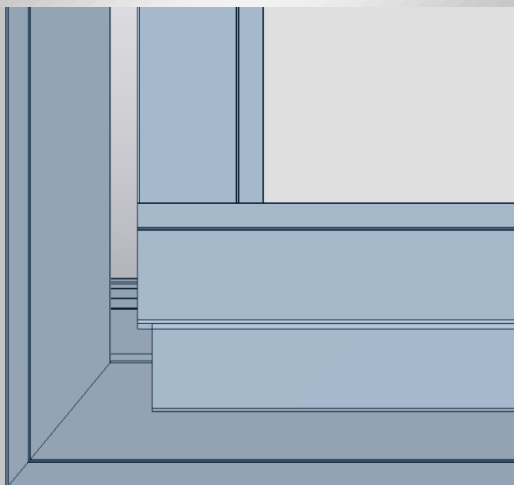

TOP AND BOTTON ALUMINIUM
PROFILE WITH FELZT

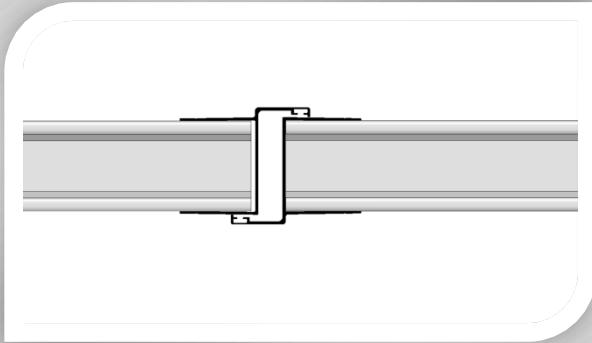

**View of the service door,
from right side.**

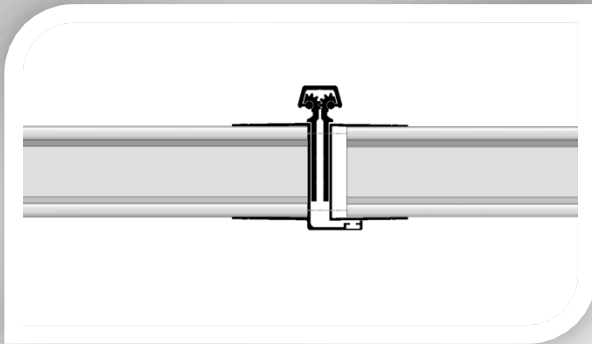

**View of the service door,
from left side.**

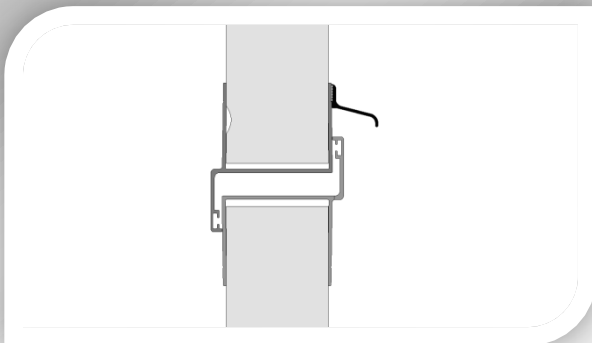

**View of the service door,
from top side.**

View of the service door.



LIST OF ELEMENTS

	No.	L [mm]	[pc]
c	2107 P01	610	2
c	2107 P02	438	2
h	2108 P01	690	2
h	2108 P02	894	1
h	2108 P03	894	1
h	2108 P04	496	1
h	2108 P05	496	1
h	2108 P06	517	2
h	2108 P07	517	2
h	2108 P08	610	6
hinge	2110 P01	610	2
hinge	2110 P02	482	2
	SEAL	125000	1
	WINDOWSILL	960	1
	RIVETS		180